

LITTLE CREEK RESIDENCE

Eugene, Oregon

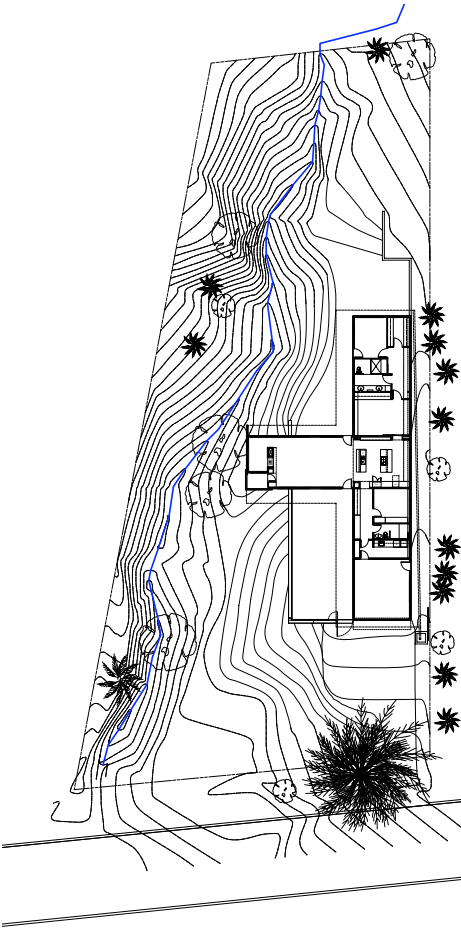

SITE

A linear north-facing lot along a seasonal creek. The neighboring house to the south is quite close, while those across the stream to the north are somewhat filtered by existing trees.

PROGRAM

A one story home for an empty-nest couple, incorporating indoor/outdoor living and the opportunity to combine cooking and entertaining. The owners - one of whom is a landscape architect - wanted to maximize the connection to the outdoors while maintaining visual privacy from the street and neighbors. They also wanted a casual entry sequence not dominated by the garage door.

SOLUTION

The house has a T-shaped plan. A north/south vertical bar is open to terraces on either side and contains the main living spaces including a small library that cantilevers out over the creek. The 'T' is completed by an east/west cross bar which incorporates the service and private areas, screening the living room and terraces from the adjacent house. The kitchen at the intersection - connects the two forms as the center of the house.

The existing driveway location, a mature cedar tree, and topography limited the garage location to the front of the house. A bifold aircraft hanger door, clad to match the house siding, allows the door to "disappear" when closed.



Some photographs of the Little Creek Residence illustrate the unfinished project while still under construction.

