

METHOW CABIN

Winthrop, Washington

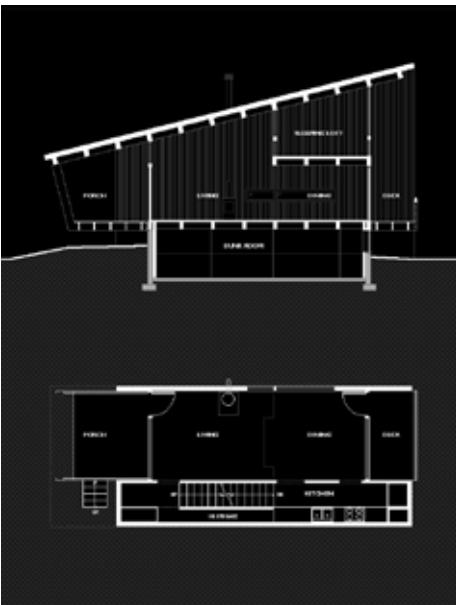

SITE

A sparse meadow adjacent to a network of cross-country skiing trails on the valley floor.

PROGRAM

A small retreat serving as a base for cross-country skiing and mountain biking. The owners wished to accommodate 6-8 people with a communal area for gathering and dining.

SOLUTION

Siting: The building is aligned with the valley, opening at the ends to focus on the views up and down the valley. The service zone shields the living spaces from the road. A slot window - positioned for seated viewing - frames skiers gliding by.

Foundation: The foundation was required to extend 4-feet below grade to a point beneath the frost line. By using 8-foot vertical forms, a single pour provided sufficient depth while raising the wood structure 4-feet above grade to protect it from snowdrifts. Sufficient ceiling height was created for

the downstairs bunkroom, with a protected at-grade window below the deck. Excavation spoils were used to form a mound for access to the entry porch.

Structure and Materials: Glulam beams with wood decking span between a wood framed fin wall and utility zone. The exterior cedar siding is continued through the living spaces to create a continuum of interior and exterior space. Steel details were designed for ease of fabrication by local agricultural welders.

Roof: The shed roof echoes the slope of the hills beyond, while allowing snow to slide off easily. There are no roof penetrations, and the simple form eliminates ridges and valleys that would be susceptible to leaks. The shed creates both a protected entry porch at the low end and a sleeping loft at the high end. Accessed from the side, the entry stair remains snow-free even as snow avalanches dramatically off the end.

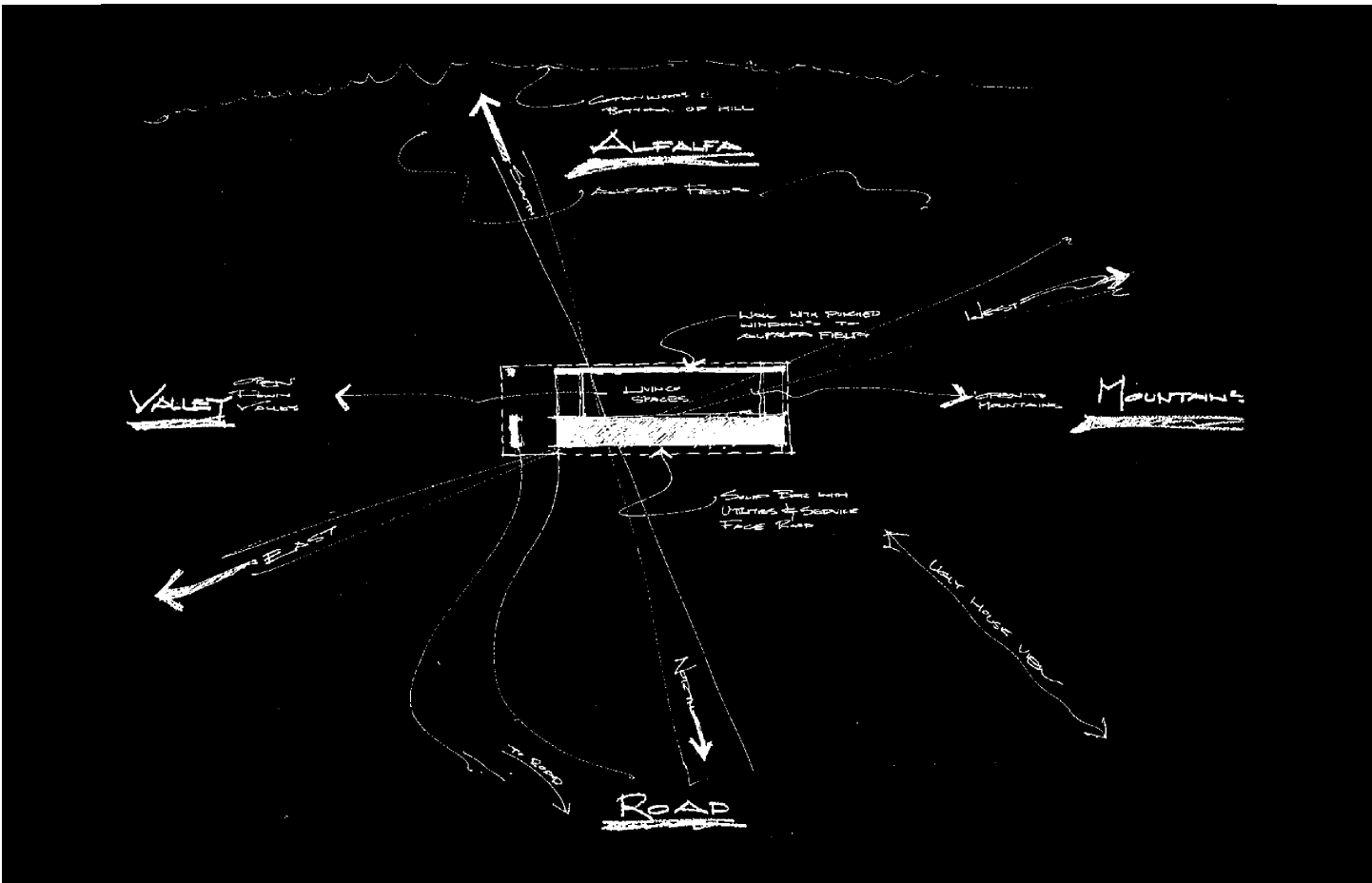







AWARDS

Honor Award - AIA Northwest and Pacific Region
2002 Awards
Citation - AIA Seattle 2001 Honor Awards for
Washington Architecture

PUBLICATIONS

House of the Month - ArchitecturalRecord.com,
October 2003
"XX Small Houses" by Chris Mathewson, due 2005
"The Contemporary Guesthouse: Building in the
Garden" by Susanna Sirefman, 2005
"25 Houses Under 1500 Square Feet" by James
Trulove, 2004
"Houses We Love: Walking in a Winter Wonder-
land" by Lydia Lee, Dwell, January/February 2003
"Coastal Retreats" by Linda Leigh Paul, 2002
"AIA Awards Celebrate New School of Simplicity"
Daily Journal of Commerce, 24 October 2001
"New Work: Three Emerging Firms" Arcade,
Autumn 2001
"Methow Cabin" Architecture Highlights, Volume
3 (China), 2004